



输出功率: 约5~80W
精密金属齿轮减速电机

OUTPUT: APPROX 5~80W
Precision Metal Gear Motor

典型应用: 智能家居
智能机器人
自动售货机
打印机

Typical Applications: Smart Home Appliance
Smart Robot
Vending Machine
Printer

1. OUTLINE DRAWING:

UNIT:MM

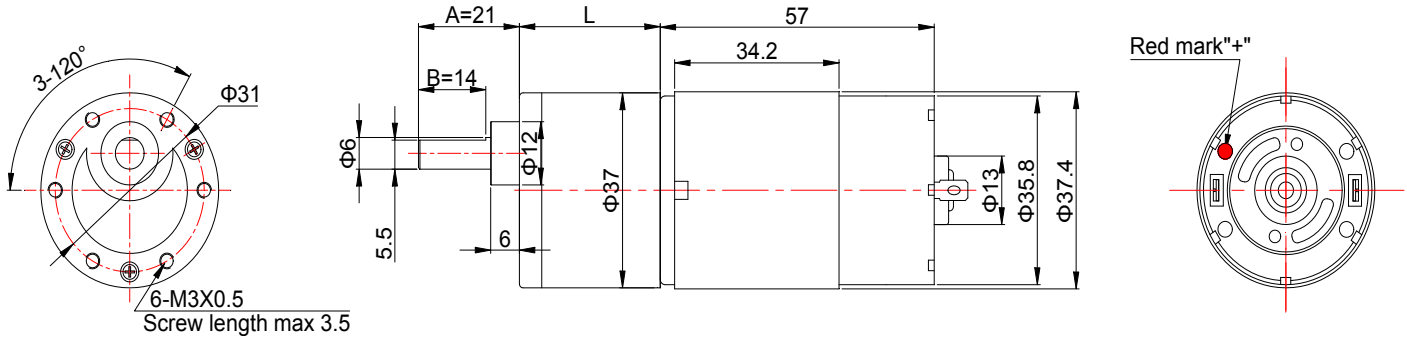

Customizable Parameters:

1. Length L、A and B
2. Electric Performance
3. Output shaft specifications
4. Reduction Ratio

WEIGHT: 330g(Approx)

View:



2. GEARBOX REDUCTION RATIO:

Gearbox Length (mm)	Stage Number	Reduction Ratio						Rated Torque	Bearable Maximum Instant Torque
		kg.cm							
21.5	2 (Enhanced)	8.9/1	10.3/1					5.0	10.0
21.5	3	18/1	26/1	31/1				5.0	10.0
24	4	40/1	46/1	55/1	68/1	79/1	93/1	7.0	13.0
26.5	5	102/1	120/1	165/1	202/1	238/1	278/1	10.0	20.0
29	6	306/1	359/1	420/1	495/1	516/1	606/1	12.0	20.0
31.5	7	666/1	782/1	918/1				15.0	25.0
31.5	5(Enhanced)	120/1						30.0	50.0

3. MOTOR PERFORMANCE :

1N.m \approx 10.2kg.cm \approx 14.2oz.in

MODEL	REDUCTION RATIO	VOLTAGE		NO LOAD			AT MAXIMUM EFFICIENCY				STALL	
		OPERATING RANGE	NOMINAL	SPEED	CURRENT	SPEED	CURRENT	TORQUE	OUTPUT	TORQUE	CURRENT	
			V	rpm	A	rpm	A	kg.cm	W	kg.cm	A	
37GB555-8.9-121200	8.9/1	5.0~14.0	12.0	1200	0.63	1032	4.4	2.5	26.46	18.0	27.6	
37GB555-18-12600	18/1	5.0~14.0	12.0	600	0.63	500	4.9	5.0	25.64	32.4	27.6	
37GB555-55-12190	55/1	5.0~14.0	12.0	190	0.63	165	4.2	13.0	22.00	99.0	27.6	
37GB555-120-1290	120/1	5.0~14.0	12.0	90	0.63	72	6.0	30.0	22.15	150.0	27.6	