



输出功率：约0.2~3.0W

精密金属齿轮减速电机

典型应用： 电子门锁
智能家居
智能机器人
电动玩具

OUTPUT:APPROX 0.2~3.0W

Precision Metal Gear Motor

Typical Applications: Electronic Door Lock
Smart Home
Smart Robot
Electric Toys

1.OUTLINE DRAWING:

UNIT:MM

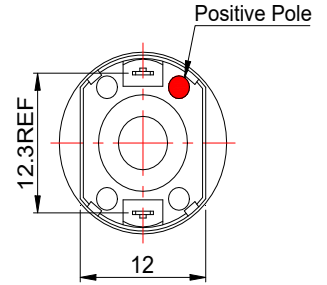
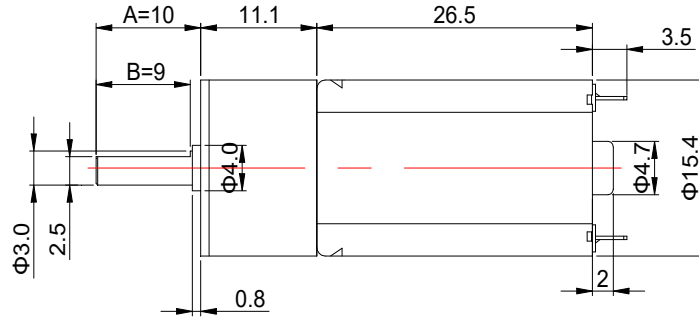
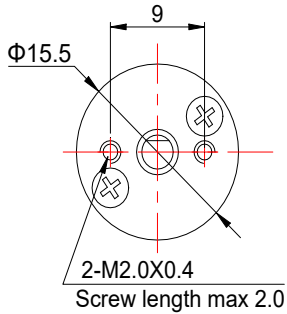

Customizable Parameters:

1. Length A and B
2. Electric Performance
3. Output shaft specifications
4. Reduction Ratio

View:



WEIGHT: 26g(Approx)

2.GEARBOX REDUCTION RATIO:

Gearbox Length (mm)	Stage Number	Reduction Ratio						Rated Troque	Bearable Maximum Instant Torque
		kg.cm							
11	2	6/1	9/1					0.2	0.5
	3	16/1	20/1	26/1	30/1			0.3	0.7
	4	35/1	52/1	60/1	63/1	85/1	100/1	0.4	0.8
	5	150/1	215/1	250/1	298/1	330/1	360/1	0.5	1.0

3.MOTOR PERFORMANCE :

1N.m≈10.2kg.cm≈14.2oz.in

FF-050SH (Metal brushes) 6.0VDC 10000rpm

MODEL	REDUCTION RATIO	VOLTAGE		NO LOAD		AT MAXIMUM EFFICIENCY				STALL	
		OPERATING RANGE	NOMINAL	SPEED	CURRENT	SPEED	CURRENT	TORQUE	OUTPUT	TORQUE	CURRENT
			V	rpm	A	rpm	A	kg.cm	W	kg.cm	A
16GR050-6-061660	6/1	3.0~7.0	6.0	1660	0.05	1330	0.23	0.05	0.68	0.25	0.95
16GR050-9-061100	9/1	3.0~7.0	6.0	1100	0.05	880	0.23	0.075	0.68	0.38	0.95
16GR050-16-06625	16/1	3.0~7.0	6.0	625	0.05	500	0.23	0.12	0.62	0.6	0.95
16GR050-20-06500	20/1	3.0~7.0	6.0	500	0.05	400	0.23	0.15	0.62	0.75	0.95
16GR050-30-06330	30/1	3.0~7.0	6.0	330	0.05	265	0.23	0.22	0.60	1.12	0.95
16GR050-52-06190	52/1	3.0~7.0	6.0	190	0.05	152	0.23	0.35	0.55	1.78	0.95
16GR050-63-06158	63/1	3.0~7.0	6.0	158	0.05	128	0.23	0.41	0.54	2.16	0.95
16GR050-85-06115	85/1	3.0~7.0	6.0	115	0.05	97	0.19	0.45	0.45	2.92	0.95

16GR050-100-06100	100/1	3.0~7.0	6.0	100	0.05	85	0.19	0.52	0.45	3.43	0.95
16GR050-150-0666	150/1	3.0~7.0	6.0	66	0.05	56	0.19	0.7	0.40	4.6	0.95
16GR050-215-0646	215/1	3.0~7.0	6.0	46	0.05	40	0.16	0.8	0.33	6.6	0.95
16GR050-250-0640	250/1	3.0~7.0	6.0	40	0.05	34	0.17	1	0.35	7.6	0.95
16GR050-298-0633	298/1	3.0~7.0	6.0	33	0.05	29	0.15	1	0.30	9.14	0.95
16GR050-360-0627	360/1	3.0~7.0	6.0	27	0.05	24	0.13	1	0.25	11	0.95

FF-050SH (Metal brushes) 12.0VDC 15000rpm											
MODEL	REDUCTION RATIO	VOLTAGE		NO LOAD		AT MAXIMUM EFFICIENCY				STALL	
		OPERATING RANGE	NOMINAL V	SPEED rpm	CURRENT A	SPEED rpm	CURRENT A	TORQUE kg.cm	OUTPUT W	TORQUE kg.cm	CURRENT A
16GR050-6-122500	6/1	3.0~13.0	12.0	2500	0.055	2100	0.23	0.05	1.08	0.31	1.12
16GR050-9-121660	9/1	3.0~13.0	12.0	1660	0.055	1370	0.24	0.08	1.12	0.46	1.12
16GR050-16-12935	16/1	3.0~13.0	12.0	935	0.055	765	0.25	0.15	1.18	0.83	1.12
16GR050-20-12750	20/1	3.0~13.0	12.0	750	0.055	610	0.25	0.17	1.06	0.91	1.12
16GR050-30-12500	30/1	3.0~13.0	12.0	500	0.055	409	0.25	0.25	1.05	1.36	1.12
16GR050-52-12285	52/1	3.0~13.0	12.0	285	0.055	233	0.25	0.39	0.93	2.16	1.12
16GR050-63-12235	63/1	3.0~13.0	12.0	235	0.055	192	0.25	0.48	0.95	2.62	1.12
16GR050-85-12175	85/1	3.0~13.0	12.0	175	0.055	143	0.25	0.64	0.94	3.54	1.12
16GR050-100-12150	100/1	3.0~13.0	12.0	150	0.055	122	0.25	0.75	0.94	4.16	1.12
16GR050-150-12100	150/1	3.0~13.0	12.0	100	0.055	81	0.25	1	0.83	5.58	1.12
16GR050-215-1268	215/1	3.0~13.0	12.0	68	0.055	59	0.19	1	0.61	7.99	1.12
16GR050-250-1260	250/1	3.0~13.0	12.0	60	0.055	53	0.17	1	0.54	9.29	1.12
16GR050-298-1250	298/1	3.0~13.0	12.0	50	0.055	45	0.15	1	0.46	11.07	1.12